



# Folding Platform Truck Owners Manual

Model MTA2-L



## Table of Contents

Introduction, General Safety Instructions .....	3
Folding Platform Truck Specifications .....	4
Folding Platform Truck Operation .....	5
Converting Folding Platform Truck Between Positions .....	6-7
List of Positions.....	8
Locking Caster Direction .....	8
Troubleshooting.....	9-10
Inspection / Maintenance Checklist.....	11

**Thank you for using the Magliner Folding Platform Truck** If you have any questions regarding this product please contact Magline Customer Service at 1-800-MAGLINE (624-5463) or (989) 512-1000. Please read this manual thoroughly to become familiar with the safe operation and maintenance of the Folding Platform Truck Convertible Hand Truck.

## General Safety Instructions

- Before using your Folding Platform Truck:
  - Carefully read this entire manual
  - Check casters for wear
  - Tighten fasteners
  - Check for bent or broken parts
  - If you see a Folding Platform Truck in need of repair, replace damaged parts immediately. Never use a Folding Platform Truck that is not in proper working order. If you use a broken Folding Platform Truck, you risk damaging the delivery and more importantly you risk injuring yourself.
- Using your Folding Platform Truck:
  - Do not exceed the weight capacity limit for the Folding Platform Truck as specified in this manual
  - Beware of pinch points identified by the labels
  - Operator should be positioned uphill from Folding Platform Truck when descending on natural grades, sloping or uneven surfaces
  - Avoid making sharp turns when pushing Folding Platform Truck
  - Keep your eyes on the path
- Loading the Folding Platform Truck:
  - Using proper alignment, lift with your legs, not your back
  - Head up, back straight
  - Never twist with your back - turn with your feet
  - When loading the Folding Platform Truck, a balanced, stable load is best
  - Your load should never block your vision
  - Don't overload - two trips are safer than one
- At the delivery:
  - Walk your path looking for obstructions, cracks, holes and uneven surfaces
  - Look for any vehicle or foot traffic
  - Note blind corners, doors and curbs
  - Take time to walk the delivery path. Be prepared for areas that could pose a problem while you deliver and try to avoid them altogether, even if it means a few extra steps.
- Folding Platform Truck storage:
  - Never leave the Folding Platform Truck unattended in an aisle
  - Always secure the Folding Platform Truck in back of truck before driving to next location

**Use the Folding Platform Truck only as specified in this manual**

## Folding Platform Truck Specifications

*Fully Expanded*

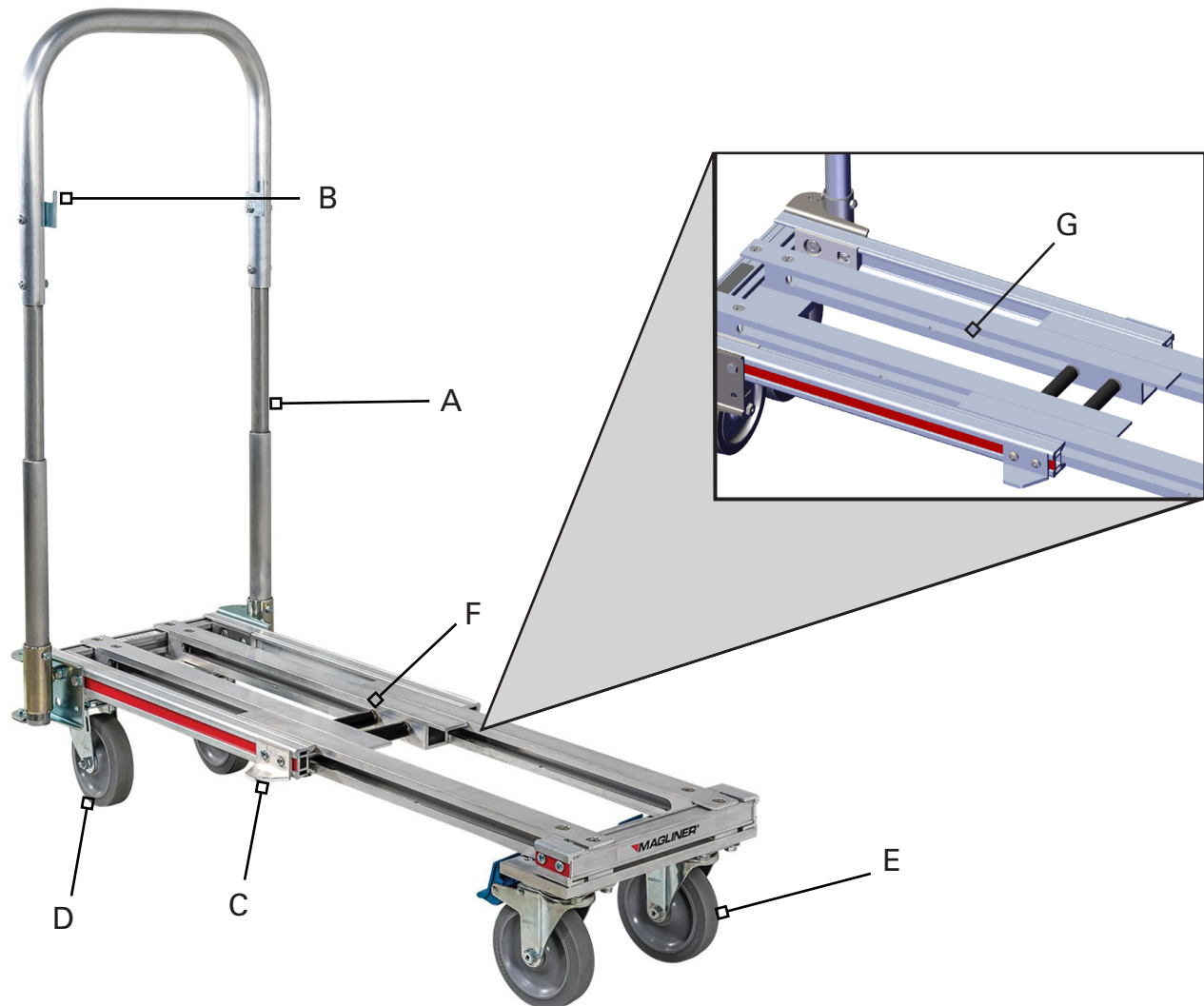

### Folding Platform Truck Components

- A. Telescopic pivoting handle
- B. Handle locking tab
- C. Frame latch
- D. 5" x 1-1/4" swivel caster
- E. 5" x 1-1/4" swivel caster with direction lock capability
- F. Frame locking rod
- G. Frame sliding groove

### Folding Platform Truck Capacity and Overall Weight

The load capacity for the Folding Platform Truck is 650 lbs. in any deck position.

The Folding Platform Truck weighs 33 lbs.

## Unfolding the Handle

**Caution:** While converting the Folding Platform Truck between the different handle positions, take care to keep hands out of the way of moving parts.

1. Slide the pivoting handle toward the rear of the cart to disengage the handle locking tabs from the frame.
2. Hold the Folding Platform Truck securely with one hand on pivoting handle and the other hand on the deck.
3. Pivot the handle slightly so that you can pull the handle upward. The handle will need to "clear" the bottom of the handle stop before fully rotating.
4. Rotate the handle upward until it is perpendicular to the ground.
5. Slide the handle tube downward until it reaches the end of travel. The handle tube must pass through bottom face of the handle stop to hold it in position.
6. The operator may place a foot on the main deck to hold the truck in place during folding motion.

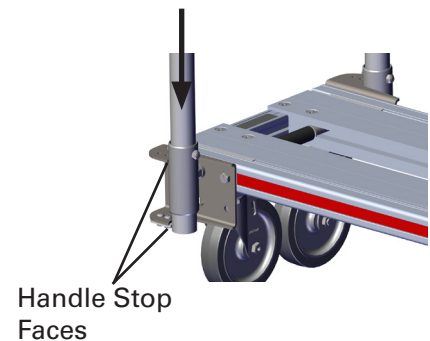
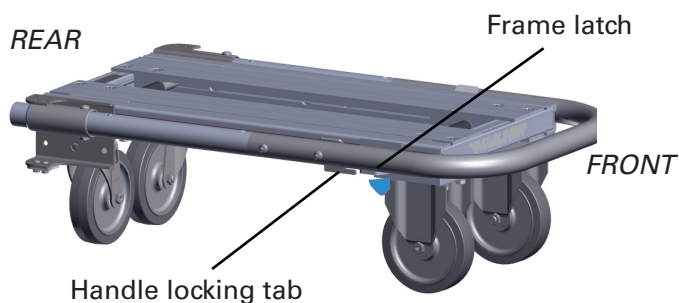

## Folding the Handle

**Caution:** While converting the Folding Platform Truck between the different handle positions, take care to keep hands out of the way of moving parts.

**Note:** The Folding Platform Truck will not fold down and lock in place if the handle is not collapsed (see "Collapsing the Handle, next page).

1. Slide the handle tube upward until it reaches the end of travel. The handle will need to "clear" the bottom of the handle stop.
2. Rotate the handle downward until it is nearly parallel with the side rails.
3. Slide the pivoting handle toward the rear of the cart to allow the handle to fully fold along the side of the cart. The operator may place a foot on the main deck to hold the truck in place during folding motion.
4. Slide the handle toward the front of the frame to engage the locking tabs on the handle with the latch on the frame side rails.
5. Before lifting the Folding Platform Truck into the upright position for storing or carrying, please be sure that the handle is latched securely in place on the frame.

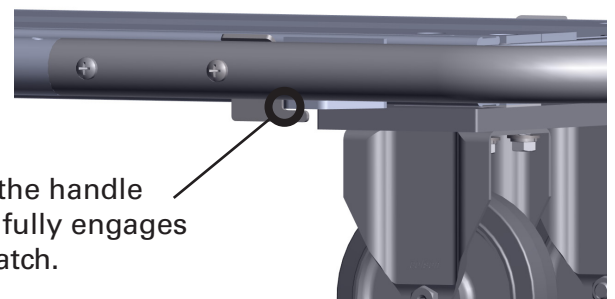
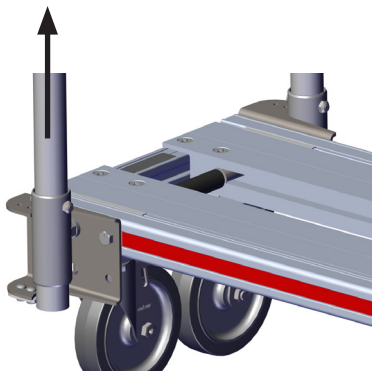

## Expanding the Handle

1. Push the handle button on one side of the pivoting handle and lift slightly to unlock the tube on that side.
2. Push the handle button on the opposite side of the pivoting handle and lift slightly to unlock the tube on that side.
3. Once both sides of the handle are unlocked, pull upward on the handle until the handle buttons lock the handle in place in the expanded position. The operator may place a foot on the main deck to hold the truck in place during expansion.
4. Make sure both handle buttons are fully engaging the holes in the top of the bottom tube before pushing or pulling the Folding Platform Truck.



## Collapsing the Handle

1. Push both handle buttons on the pivoting handle and gently push downward. The handle should slide with ease; avoid too much force which may cause the tubes to bend.
2. Keep pushing the handle downward until the handle buttons engage the holes in the bottom of the bottom tube.
3. Make sure both handle buttons are fully engaging the holes in the bottom of the bottom tube before pushing or pulling the Folding Platform Truck.

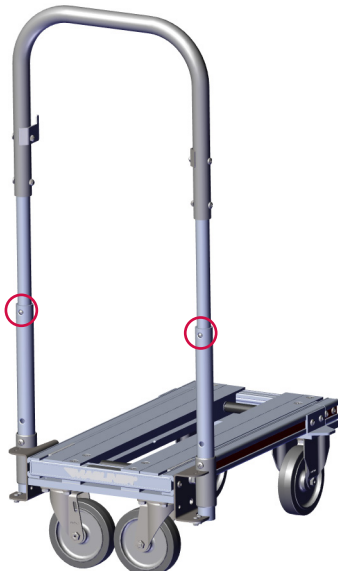

## Expanding the Deck

**Caution:** While converting the Folding Platform Truck deck between different positions, take care to keep hands out of the way of moving parts.

1. Place your hands on the frame locking rods, as shown.
2. Slightly lift the rods to move them out of the locked position.
3. Slide the rods toward each other within the frame sliding grooves.
4. The first locking slot will lock the deck into its middle position. To lock the deck in the middle position, allow the rear most locking rod to drop into this locking slot.
5. To expand the deck into its longest position, slightly lift the rods and slide them toward each other until the deck is in the outermost position.
6. Drop the rear most locking rod to rest in the outermost locking slot.



Figure 1

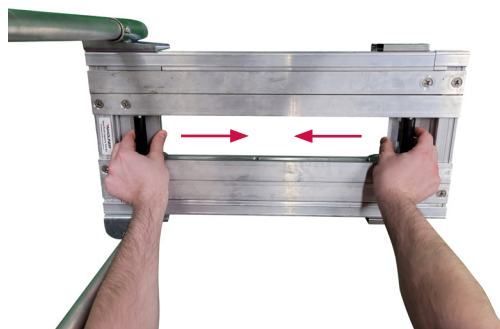

Figure 2

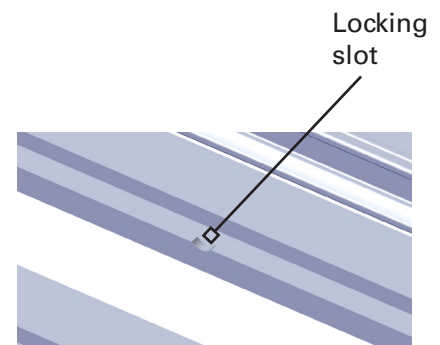

Figure 3

## Collapsing the Deck

**Caution:** While converting the Folding Platform Truck deck between different positions, take care to keep hands out of the way of moving parts.

1. Place your hands on the frame locking rods, as shown, using your thumbs on the locking rods and keep your other fingers raised above the deck.
2. Lift upward slightly to move the rear most locking rod out of the locked position.
3. Carefully slide the rods away from other within the frame sliding groove, being careful to keep your knuckles out of the way of the caster mounting plates as the frame is fully collapsed.
4. Drop the rear most locking rod to rest in the desired locking slot.



Figure 4

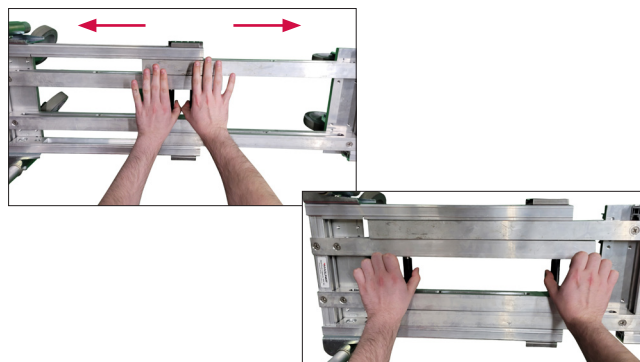

Figure 5

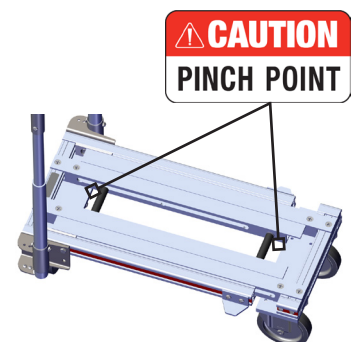
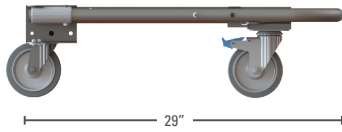

Figure 6

## List of Positions

### 2 Dolly Positions



### 6 Platform Truck Positions

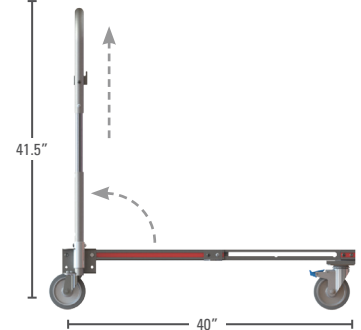
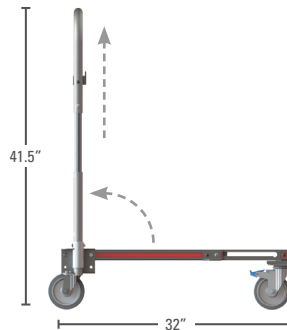
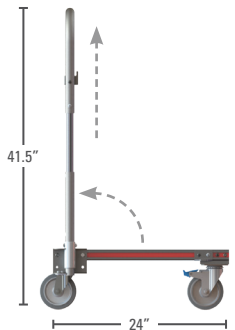
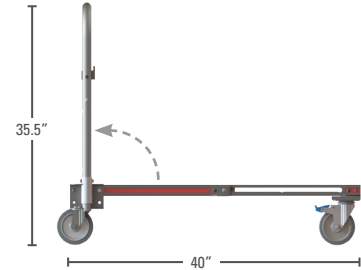
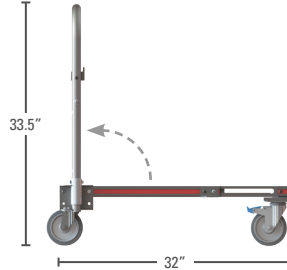
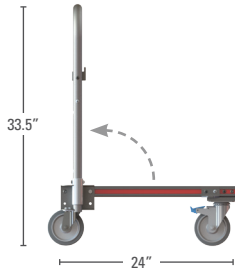

### Locking Caster Direction

The front two casters of the platform truck include directional locks to assist with moving the load in a straight direction. It is NOT a caster brake which prevents the caster wheel from rotating around the axle bolt; instead, it prevents the caster from swiveling so that the truck has two swivel casters in the rear and two rigid casters in the front.

To lock direction:

1. Use your foot to gently press downward on the back of the blue locking tab to set the lock as shown.
2. Once the locking tab is pressed down, the caster will rotate only until it is oriented parallel to the frame rails, then will lock into place.

To unlock direction:

1. Use your foot to gently press downward on the front of the blue locking tab to unlock the caster as shown.
2. The caster should now swivel freely.

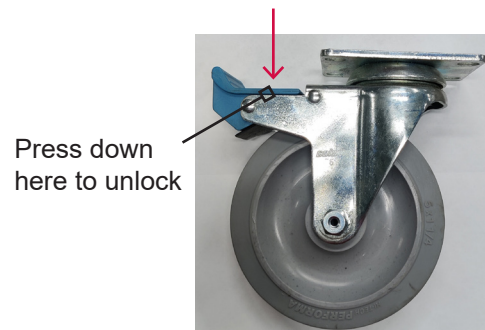
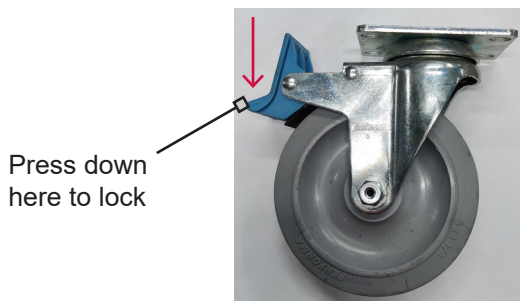



## Troubleshooting

Problem	Possible Causes	Remedy
The pivoting handle is difficult to transition between folding and unfolded positions.	Pivoting handle	<p>If the pivot handle is bent or damaged, it should be replaced.</p> <p>Check for burrs on the pivoting handle. File or sand the burrs until they're smoothed out, or replace the pivoting handle.</p>
	Pivot sockets	If the pivot sockets are damaged or worn, replace them.
The pivoting handle is difficult to transition between expanded and collapsed positions.	Pivoting handle tubing	<p>If any part of the handle tubing is bent, it should be replaced.</p> <p>Check for burrs on the pivoting handle. File or sand the burrs until they're smoothed out, or replace the pivoting handle.</p>
	Handle locking buttons	If the handle locking buttons are damaged, they should be replaced.
The pivoting handle does not lock securely to the frame.	Frame	Check the frame latch components. If they are loose, tighten them.
	Pivoting handle	Check the handle locking tabs. If they are bent or damaged, replace them.
The deck is difficult to transition between different deck lengths.	Frame	<p>Clean any debris within the frame slots.</p> <p>If the sliding rods are damaged, replace them.</p> <p>If the sliding rods are out of place, try to move them into the correct position.</p> <p>Check the frame latch components. If they are loose, tighten them.</p> <p>If any components are missing or damaged, replace them.</p>
The frame will not lock securely into the different deck lengths.	Frame	<p>Clean any debris within the locking slots.</p> <p>If the sliding rods are damaged, replace them.</p> <p>If the sliding rods are out of place, try to move them into the correct position.</p> <p>Check the frame latch components. If they are loose, tighten them.</p> <p>If any components are missing or damaged, replace them.</p>

Problem	Possible Causes	Remedy
The Folding Platform Truck does not roll smoothly.	Casters	Check to see if the caster wheels are loose within the brackets.  Check to see if the brackets on the casters are bent or broken.  Make sure the casters swivel easily.  Check for flat spots on the caster wheels.  Replace worn, damaged or missing components.

If you have any difficulty with any area of the Folding Platform Truck, please contact Magline Customer Service at 1-800-MAGLINE (624-5463) or (989) 512-1000.

Inspection Date: \_\_\_\_\_ Customer Location: \_\_\_\_\_

Inspector's Name: \_\_\_\_\_

Area	Description	Method of Inspection	Normal Condition	Findings Pass or Fail	Timing	Notes
General Inspection	Folding Platform Truck is straight and properly aligned	Visual inspection	<ul style="list-style-type: none"> <li>• Frame is not twisted or bent</li> <li>• Lock rods are not bent or damaged</li> <li>• Telescopic pivoting handle is not bent or damaged</li> </ul>		Daily	
General Inspection	Folding Platform Truck shows no damage or excessive wear	Visual inspection	<ul style="list-style-type: none"> <li>• Straight sections</li> <li>• Smooth curves</li> <li>• Flat surfaces</li> </ul>		Daily	
General Inspection	Pivoting handle folds and unfolds properly	Follow steps to fold and unfold pivoting handle	Pivoting handle should easily move between folding and unfolded positions (some lubrication may be required over time)		Daily	
General Inspection	Pivoting handle expands and collapses properly	Follow steps to expand and collapse pivoting handle	Pivoting handle should easily move between expanded and collapsed positions (some lubrication may be required over time)		Daily	
General Inspection	Deck expands and collapses properly	Follow steps to expand and collapse deck	Deck should easily move between expanded and collapsed positions (some lubrication may be required over time)		Daily	
General Inspection	Folding Platform Truck wheels are in good condition	Visual inspection	<ul style="list-style-type: none"> <li>• There should be no chunks missing from the caster wheel material</li> <li>• The caster hub is not cracked or damaged</li> </ul>		Daily	
General Inspection	Fasteners	Visual inspection	<ul style="list-style-type: none"> <li>• No loose fasteners</li> <li>• No missing fasteners</li> </ul>		Daily	

***Magline, Inc.***  
1205 W. Cedar Street • Standish, MI 48658 USA  
1-800-MAGLINE (624-5463) • (989) 512-1000 (outside U.S. & Canada)  
[www.magliner.com](http://www.magliner.com)