

MANUAL COOLIFT® PART DIAGRAMS

Center Wheels, Brake Disc

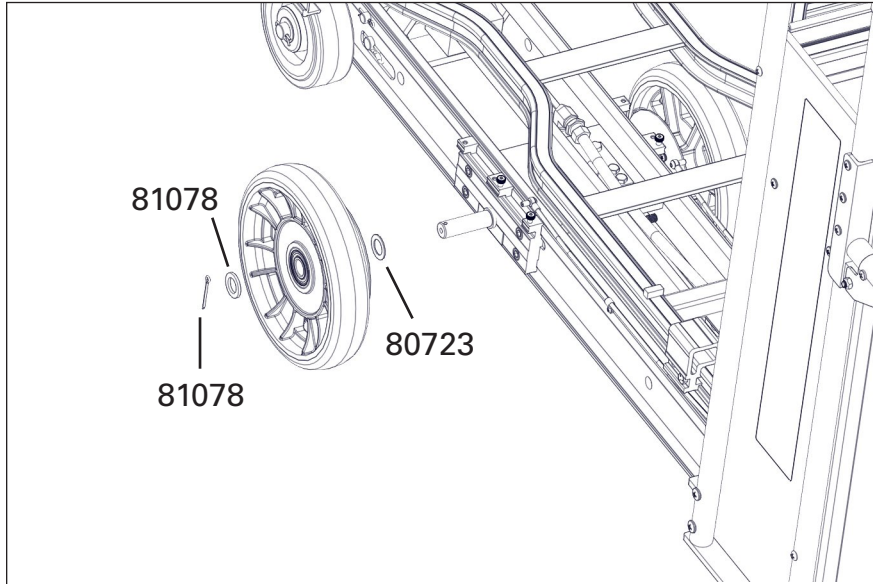

Description	Part Number
Cotter pin - 1/8" x 1-1/2" long	81078
Washer - 1.25" x .796" x .125"	80718
Washer - 1.25 x .796 x .0478	80723

TOOLS REQUIRED

- NEEDLE NOSED PLIERS
- HAMMER

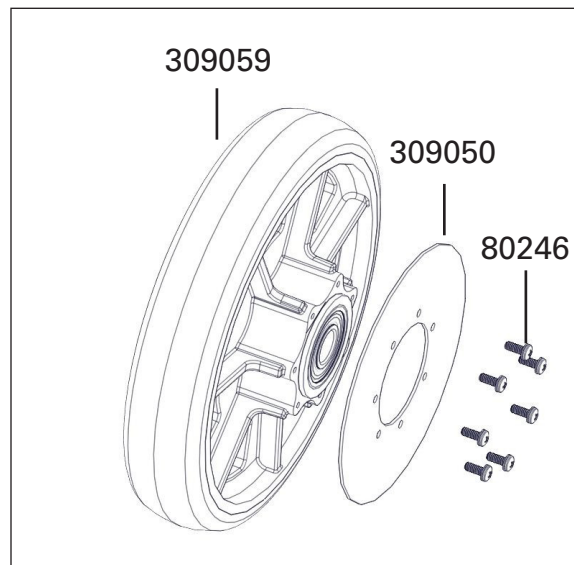

NOTE: Apply medium-strength (blue) threadlocker on all screws before assembly.

Description	Part Number
Center wheel - 10" x 2" mold-on rubber with deep groove ball bearings	309059
Brake disc for center wheel	309050
Pan head machine screw - #10-24 UNF x 3/8" long	80246

TOOLS REQUIRED

- 5mm WRENCH
- #2 PHILLIPS SCREWDRIVER
- MEDIUM STRENGTH (BLUE) THREADLOCKER

Front Axle, Caster Wheels

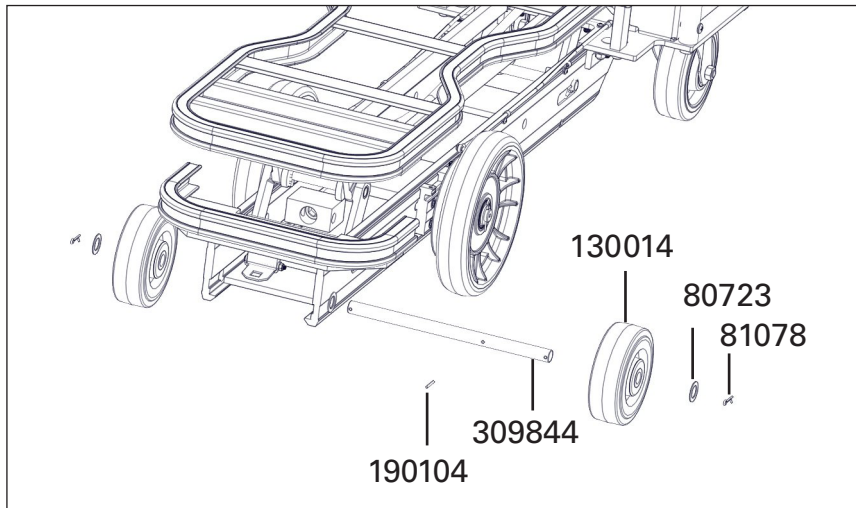

Description	Part Number
Cotter pin - 1/8" x 1-1/2" long	81078
Washer - 1.25 x .796 x .0478	80723
Roll pin - 1/8" x 1-1/8" long	190104
Caster wheel - 6" x 2" gray flat tread	130014
Axle - 19.5" long x .75" diameter	309844

TOOLS REQUIRED

- NEEDLE NOSED PLIERS
- HAMMER

Cabinet Door

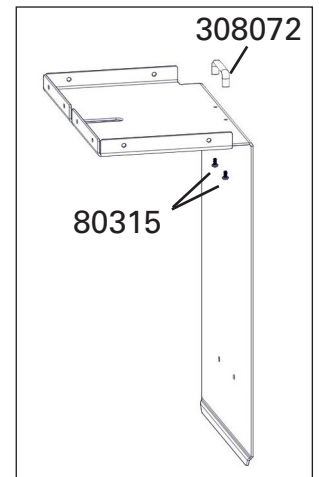
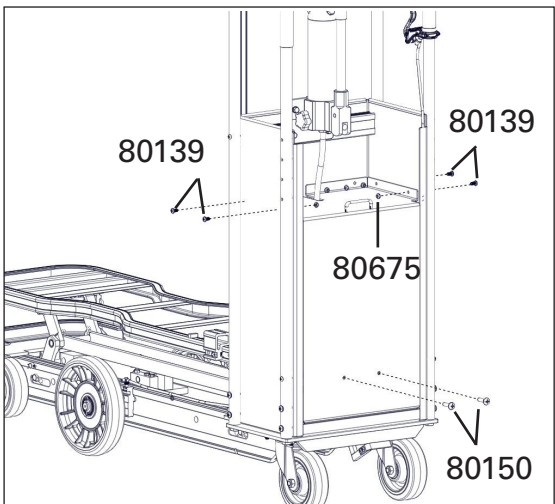

Description	Part Number
Pan head machine screw - 1/4"-20 x 1-1/2" long	80139
Hex lock nut - 1/4"-20	80675
Pan head machine screw - 5/16"-18 x 1-1/4" long	80150
Cabinet door	315081
Door handle	308072
Thread forming machine screw - #10-32 x 3/8" long	80315

TOOLS REQUIRED

- 7/16" WRENCH
- #2 PHILLIPS SCREWDRIVER
- #4 PHILLIPS SCREWDRIVER

Rear Casters

NOTE: Remove four screws from each caster cap to release the caster. These screws are part of the caster assembly and not available as replacement parts.

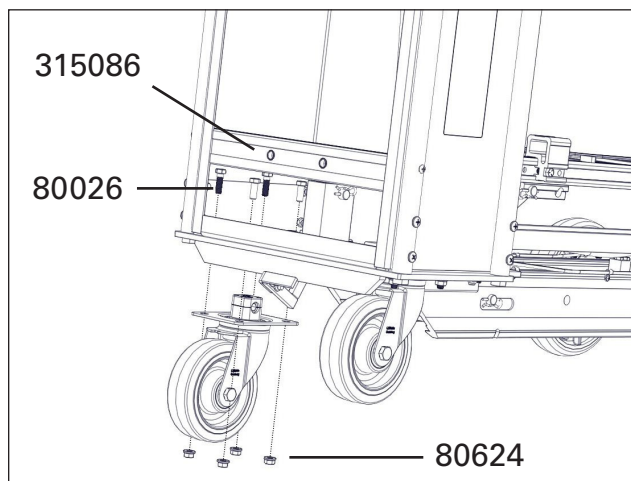
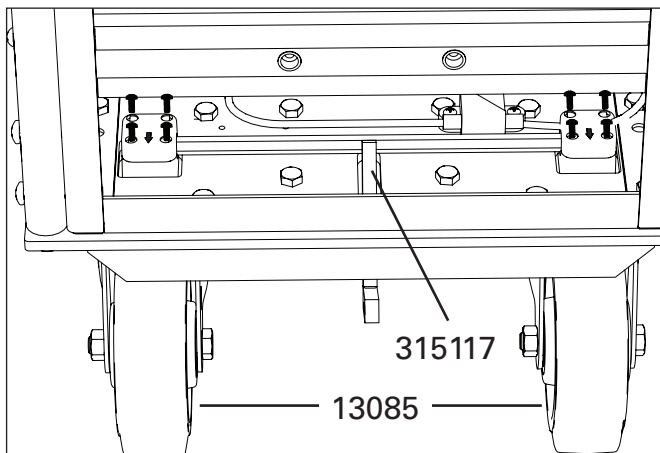

Description	Part Number
Caster - 6" x 2" gray TPR, swivel, with top brake	13085
Caster brake weldment	315117
Hex head cap screw - 3/8"-16 x 1-1/4" long	80026
Hex lock nut with flange - 3/8"-16	80624
Cross brace assembly	315086

TOOLS REQUIRED

- (2) 1/2" WRENCHES
- (1) T20 TORX SCREWDRIVER/
BIT

Brake Foot Pedal

NOTE: Remove four screws from each caster cap to release the caster and foot pedal rod (see above).

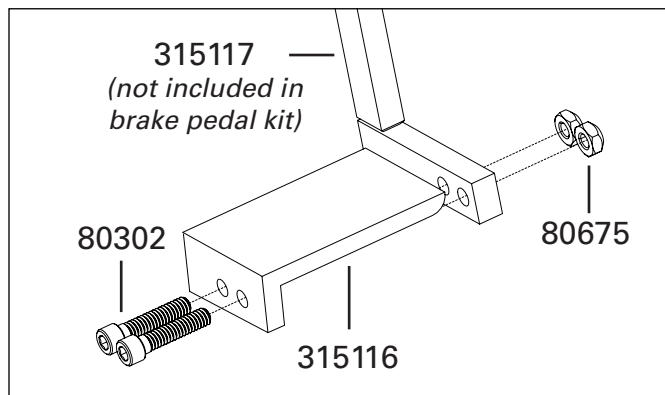
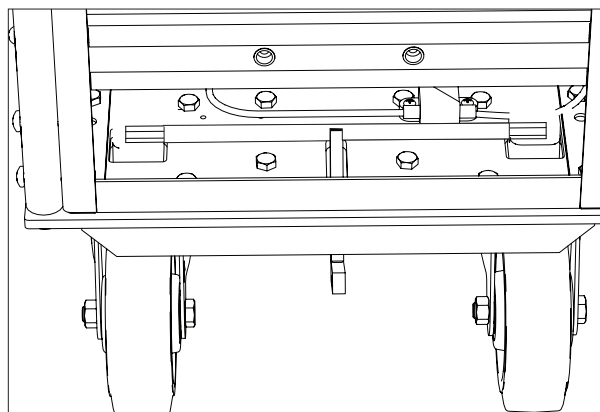

Description	Part Number
Caster brake weldment	315117
Brake pedal kit <i>includes items below:</i>	86214
Socket head cap screw - 1/4"-20 x 1-1/8" long	80302
Hex lock nut - 1/4"-20	80675
Brake pedal	315116

TOOLS REQUIRED

- 7/16" WRENCH
- #2 PHILLIPS SCREWDRIVER
- (1) T20 TORX SCREWDRIVER/
BIT

Pallet Stop

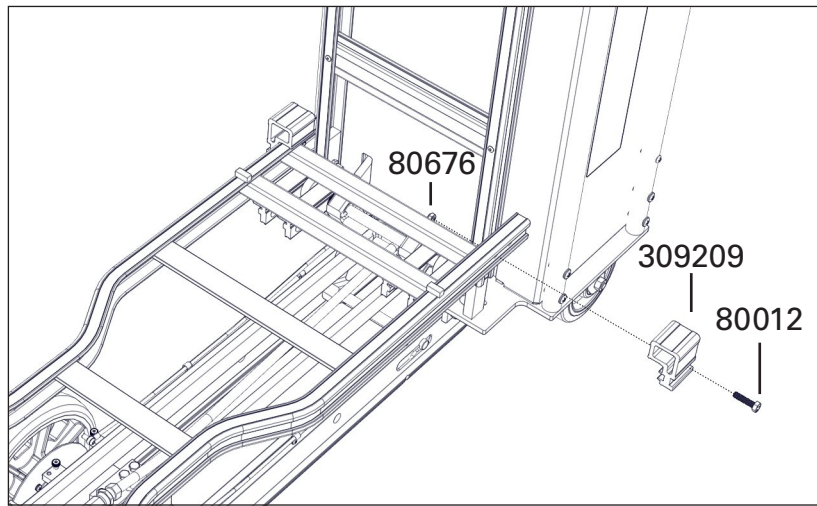

Description	Part Number
Hex head cap screw - 5/16" -18 x 1-1/4" long	80012
Hex lock nut - 5/16"-18	80676
Pallet stop	309209

TOOLS REQUIRED

- (2) 1/2" WRENCHES

Containment Strap and Bulk Head

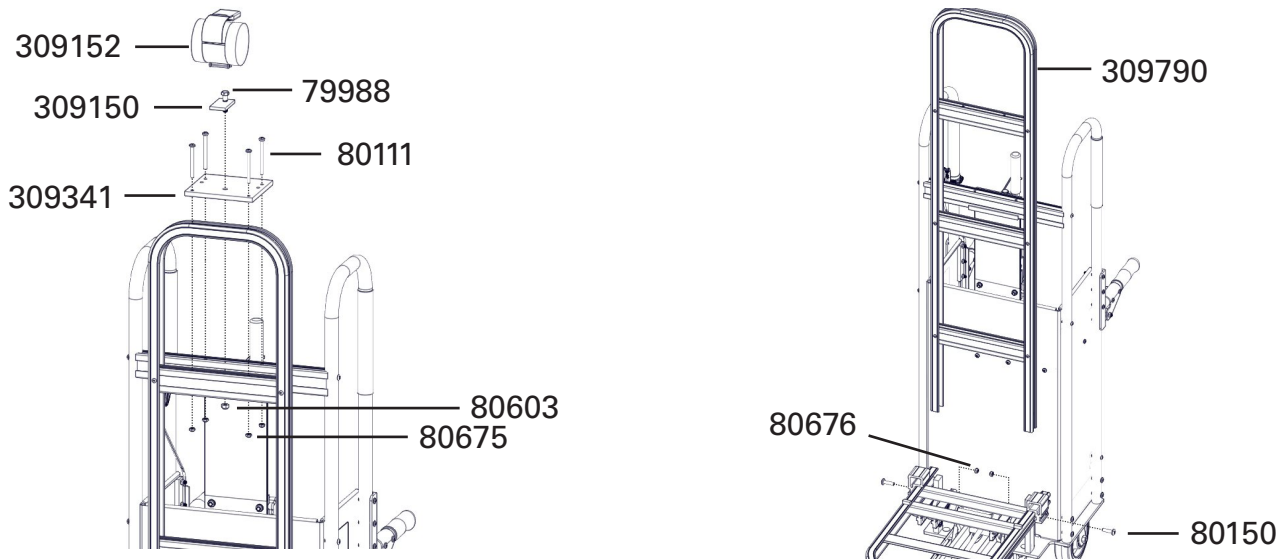

Description	Part Number
Containment strap	309152
Hex head cap screw - 3/8"-16 x 1-1/2" long	79988
Containment strap spacer	309150
Saddle plate for CMH43	309341
Pan head machine screw - 1/4"-20 x 2-3/4" long	80111
Hex lock nut - 3/8"-16	80603
Hex lock nut - 1/4"-20	80675
Bulk head for CMH43	309790
Pan head machine screw - 5/16"-18 x 1-1/4" long	80150
Hex lock nut - 5/16"-18	80676

TOOLS REQUIRED

- 7/16" WRENCH
- 1/2" WRENCH
- #2 PHILLIPS SCREWDRIVER
- #4 PHILLIPS SCREWDRIVER

Hydraulic Pump, Brake Line

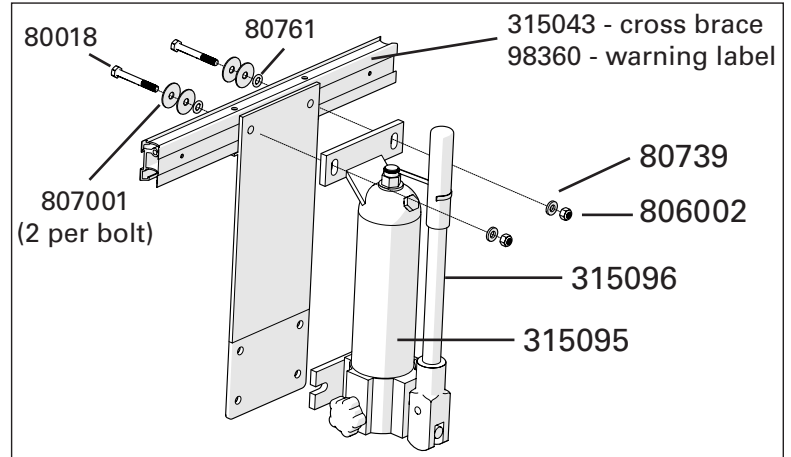
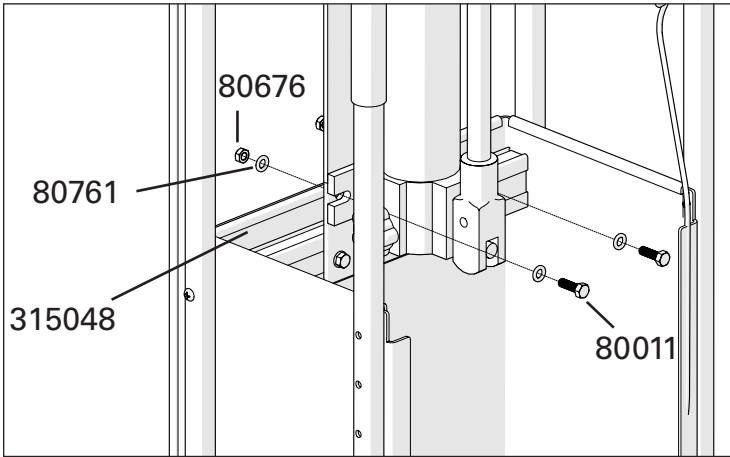

Description	Part Number
Hydraulic pump with handle	315095
Replacement pump handle	315096
Pump mount plate	315071
Hex head cap screw- 5/16"-18 x 2-1/2" long	80018
Hex head cap screw- 5/16"-18 x 1" long	80011
Washer - 5/16" (thick)	80761
Washer - 5/16" (thin)	80739
Washer - 5/16" (oversized)	807001
Hex lock nut - 5/16"-18	80676
Hex lock nut with nylon insert - 5/16"-18	806002
Cross brace for handle	315043
Warning label	98360
Cross brace assembly	315048
Brake line (fully bled)	315090

TOOLS REQUIRED

- (2) 1/2" WRENCHES
- #4 PHILLIPS SCREWDRIVER
- ABSORBENT TOWELS
- SHALLOW DRIP PAN

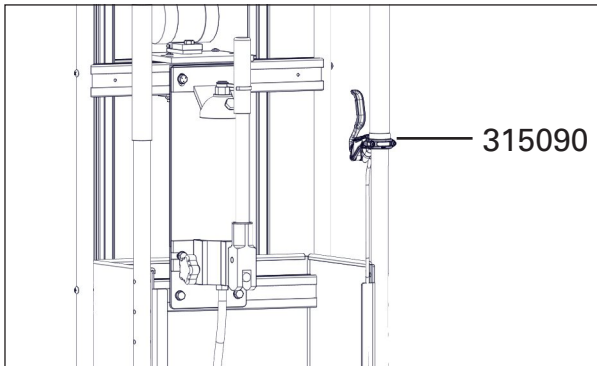

Description	Qty. per Line Repaired	Part Number
Hose nut	1	315097
Hose insert bushing	1	315098

IMPORTANT NOTE: Finish tightening using a torque wrench set at 70 in/lbs. This will properly crimp the hose insert bushing onto the line.

The brake system will now need to be bled to remove air and restore proper braking function. Please use this video for instruction: <https://youtu.be/Y4AfxwMV6UU>

TOOLS REQUIRED

- (1) #3 PHILLIPS SCREWDRIVER
- (1) 7/16" WRENCH OR SOCKET WRENCH
- (1) BRAKE LINE CUTTING TOOL (SHARP BOX CUTTER, TUBING CUTTER)
- (1) 8MM TORQUE WRENCH



Deck Removal

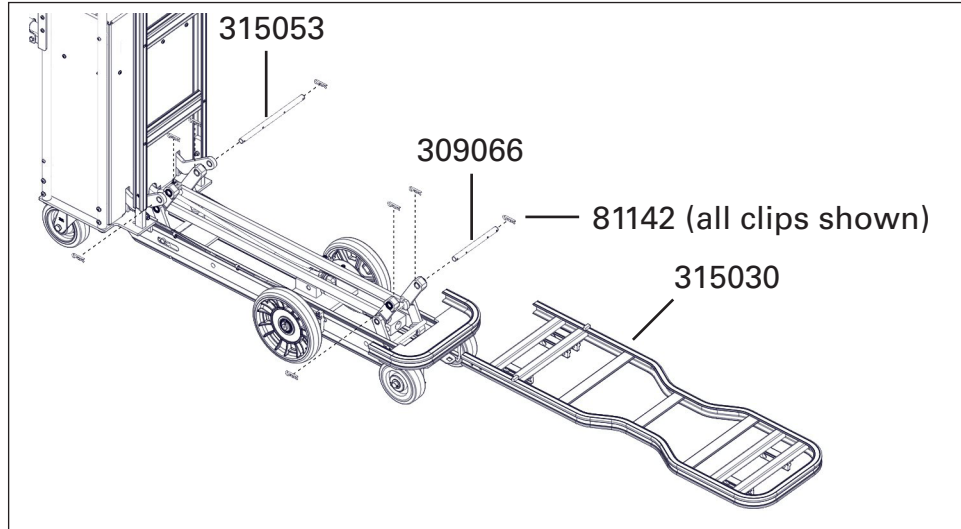

Description	Part Number
Deck weldment	315030
Straight hair pin clip - 5/8"	81142
Link pin - 8" long	309066
Link pin - upper rear swing link	315053

TOOLS REQUIRED

- NEEDLE NOSE PLIERS

Front Cylinder

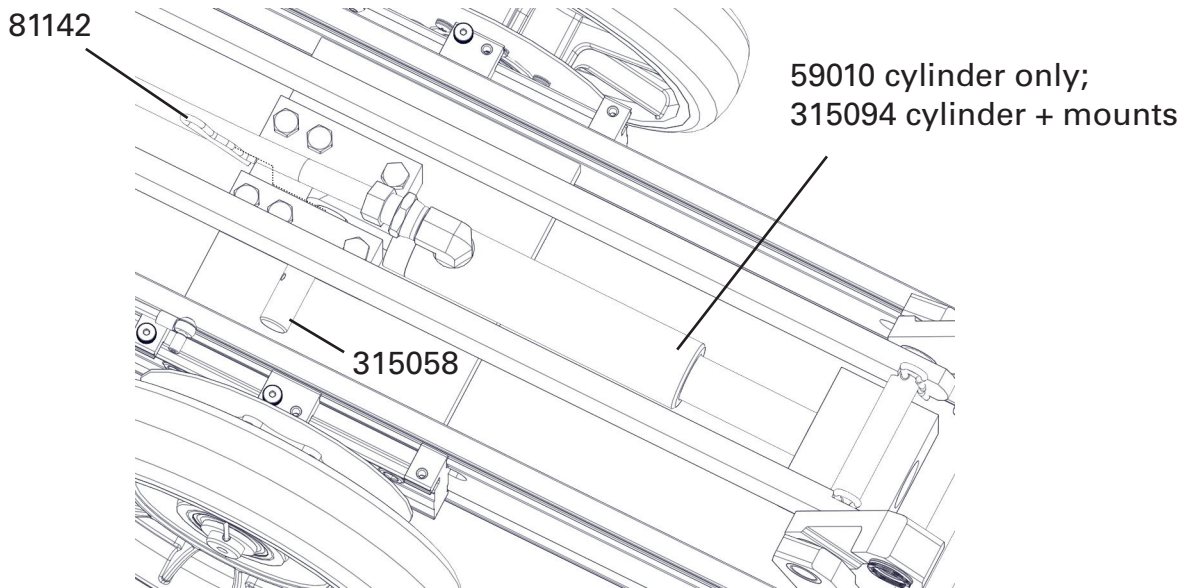

Description	Part Number
Front cylinder with mounts	315094
Front cylinder (only, no mounts)	59010
Straight hair pin clip - 5/8"	81142
Front cylinder pin	315058

TOOLS REQUIRED

- NEEDLE NOSE PLIERS

Deck Linkage System

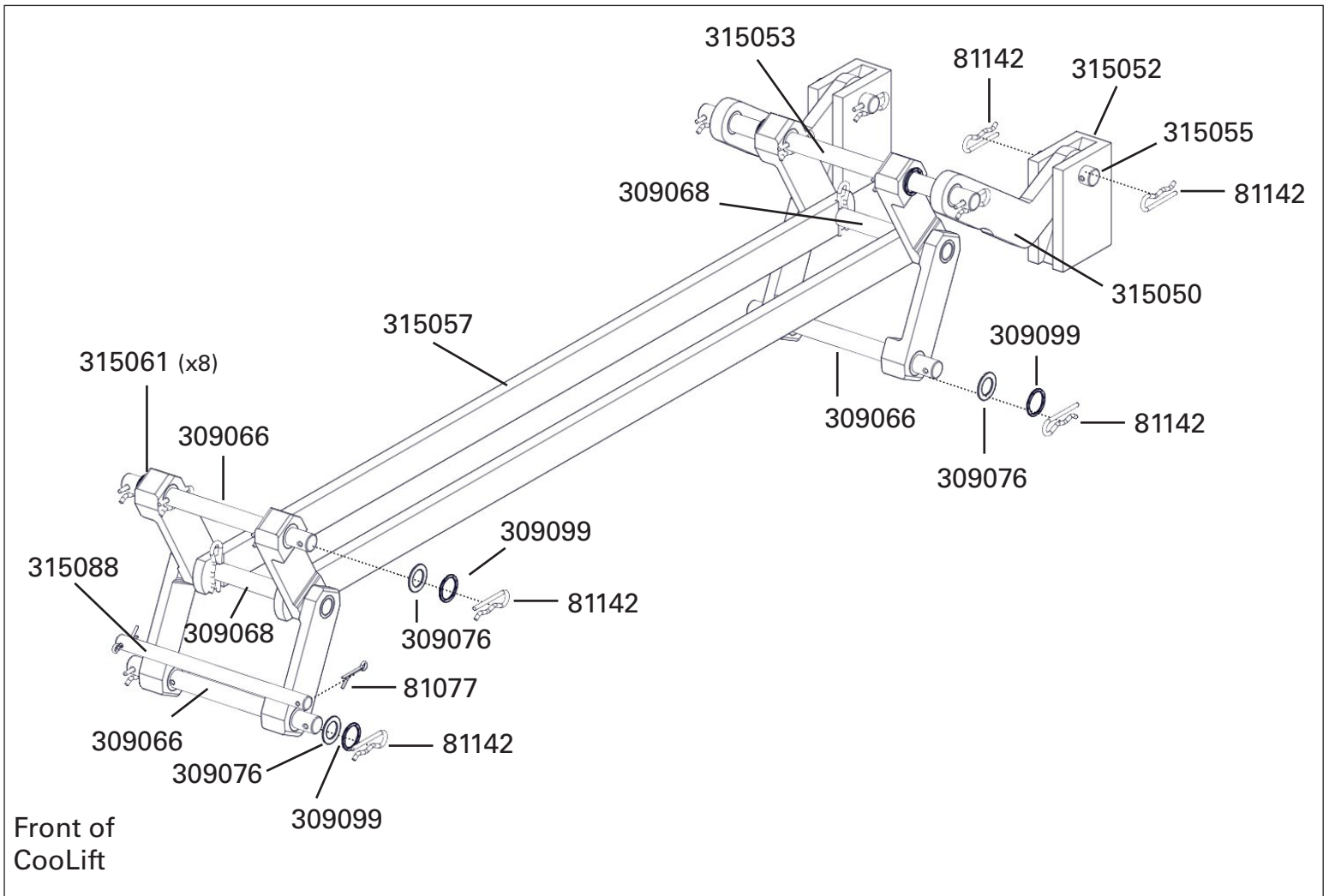

Description	Part Number
Cotter pin - 1/8" x 1" long	81077
Straight hair pin clip - 5/8"	81142
Wave spring	309099
Arbor shim	309076
Shaft for deck stop	315088
Link pin - 8" long	309066
Link pin - 6-1/4" long	309068
Link pin - upper rear swing link	315053
Link pin - swing link inside enclosure	315055
Link assembly with bushing installed	315061
Rear swing link with bearing	315050
Rear link pivot block	315052
Main sync link	315057

TOOLS REQUIRED

- NEEDLE NOSE PLIERS
- MALLET

User Handle

Note: If your model has the optional lifting handles, please see instructions for lifting handle removal first.

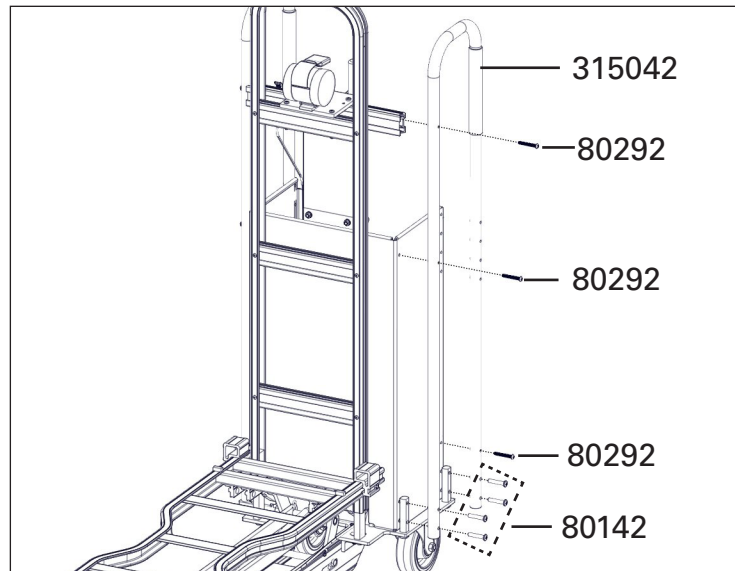

Description	Part Number
User handle with foam grip	315042
Pan head machine screw - 1/4"-20 x 2" long, self tapping	80292
Pan head machine screw - 5/16"-18 x 1-3/4" long	80142
Hex lock nut - 5/16"-18 (inside enclosure, not shown)	80676

TOOLS REQUIRED

- 1/2" WRENCH
- #2 PHILLIPS SCREWDRIVER
- #4 PHILLIPS SCREWDRIVER

Optional Lifting Handle

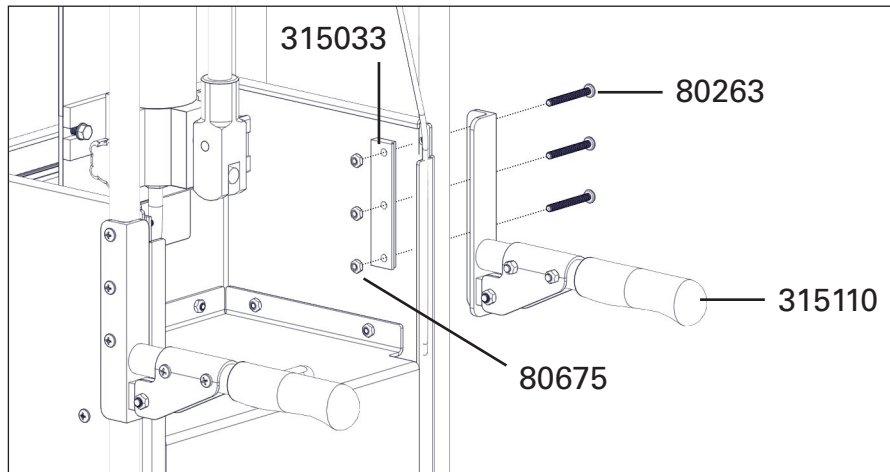

Description	Part Number
Lift assist handle assembly	315110
Lift assist handle backing plate	315033
Pan head machine screw - 1/4"-20 x 2-1/4" long	80263
Hex lock nut - 1/4"-20	80675

TOOLS REQUIRED

- 7/16" WRENCH
- #2 PHILLIPS SCREWDRIVER