

# ASSEMBLY INSTRUCTIONS

## Bulk Delivery Trucks

- Commercial Bulk Delivery Truck
- Industrial Bulk Delivery Truck

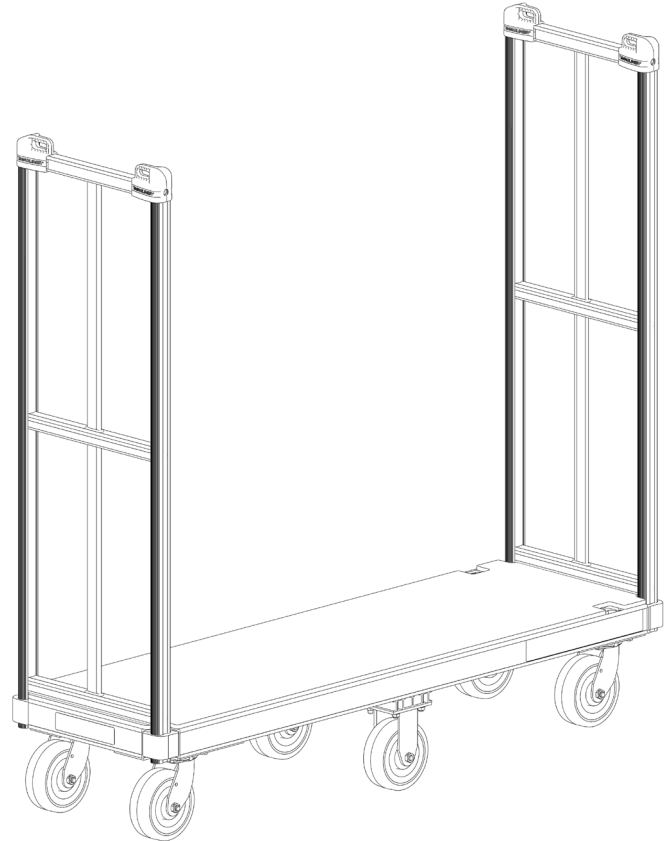
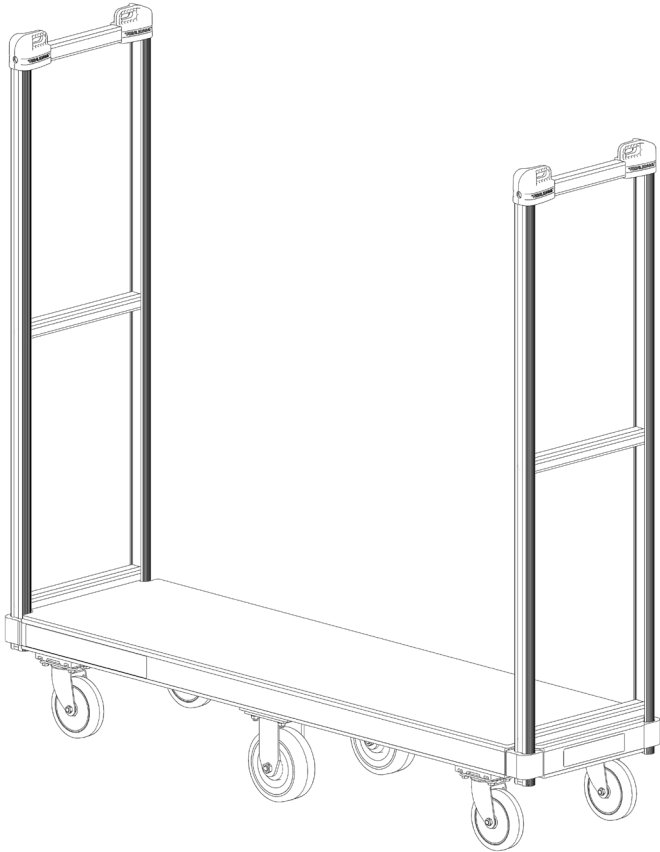

## Table of Contents:

Commercial Bulk Delivery Truck	
Assembly Instructions .....	2
Industrial Bulk Delivery Truck	
Assembly Instructions .....	3
Industrial Bulk Delivery Truck, Soft Drink	
Option Assembly Instructions .....	4



# COMMERCIAL BULK DELIVERY TRUCK PARTS LIST

Description	Qty.	Part No.
Deck - 16" wide x 60" long	1	306175
Handle	2	306167
Caster - 5" x 1-1/4" thermoplastic rubber swivel caster	4	130063
Caster - 6" x 2" thermoplastic rubber rigid caster	2	130067
4" x 2-1/2" swivel caster spacer plate	Bag of 4	86164
Hardware Pack (consists of items below)		86624
Hex head cap screw - 5/16"-18 x 1-1/2" long	16	80013
Flat washer for 5/16" bolt	16	80701
Flanged hex lock nut - 5/16"-18	16	80627
Hex head cap screw - 3/8"-16 x 1-1/4" long	8	80026
Flat washer for 3/8" bolt	8	80728
Flanged hex lock nut - 3/8"-16	8	80624

## REQUIRED TOOLS

- (1) STANDARD 1/2" WRENCH
- (1) STANDARD 9/16" WRENCH
- (1) STANDARD SOCKET WRENCH
- (1) STANDARD 1/2" SOCKET
- (1) STANDARD 9/16" SOCKET

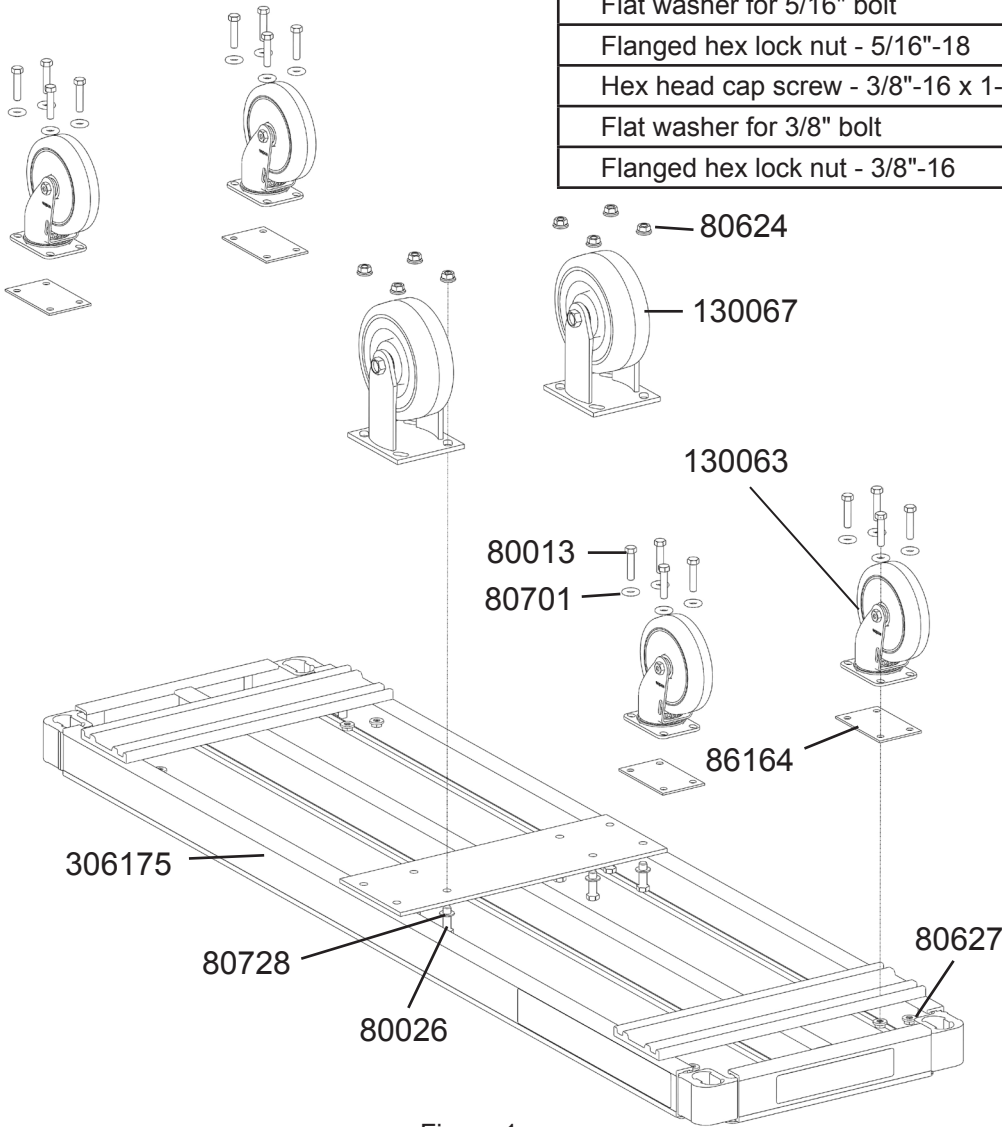

Figure 1

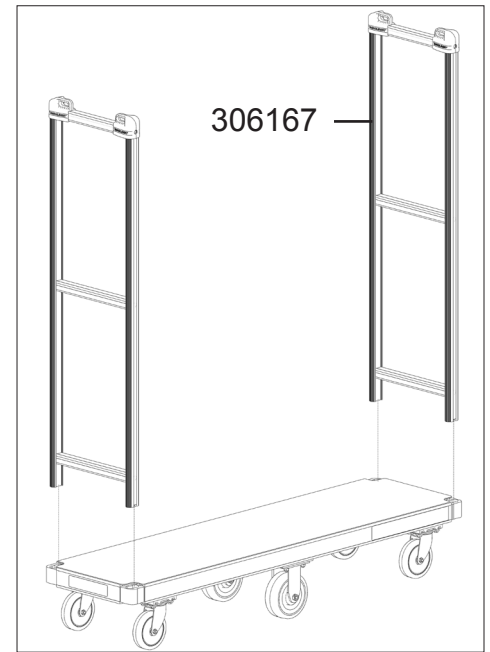

Figure 2

## CASTER ASSEMBLY INSTRUCTIONS

1. Using the 5/16"-18 x 1-1/2" hex head screws, 5/16" washers and 5/16"-18 flanged lock nuts, attach all four of the swivel caster plates and the 5" swivel casters onto the deck as shown in Figure 1.
2. Using the 3/8"-16 x 1-1/4" long hex head screws, the 3/8" washers and the 3/8"-16 flanged lock nuts, attach both of the 6" rigid casters onto the deck as shown in Figure 1.
3. Position the handle as shown in Figure 2 and insert it into the sockets of the deck.

**NOTE:** Tighten all bolts securely. (Recommended: The 5/16"-18 bolts should be tightened to a torque value of 10-11 ft-lbs. and the 3/8"-16 bolts should be tightened to a torque value of 23 ft-lbs.)

# INDUSTRIAL BULK DELIVERY TRUCK

## REQUIRED TOOLS

- (1) STANDARD 9/16" WRENCH
- (1) STANDARD SOCKET WRENCH
- (1) STANDARD 9/16" SOCKET

Description	Qty.	Part No.
Deck - 18" wide x 60" long	1	306250S
Handle	2	306150
Caster - 6" x 2" thermoplastic rubber swivel caster	4	130066
Caster - 6" x 2" thermoplastic rubber rigid caster	2	130067
Hardware Pack (consists of items below)	1	86450
Hex head cap screw - 3/8"-16 x 2" long	8	80029
Hex head cap screw - 3/8"-16 x 1-1/4" long	8	80026
Carriage bolt - 3/8"-16 x 1" long	8	80127
Flat washer for 3/8" bolt	8	80728
Flanged lock nut - 3/8"-16	16	80624

Note: 8" caster models use four 8" x 2" thermoplastic rubber swivel casters (130079) and two 8" x 2" thermoplastic rubber rigid casters (130029).

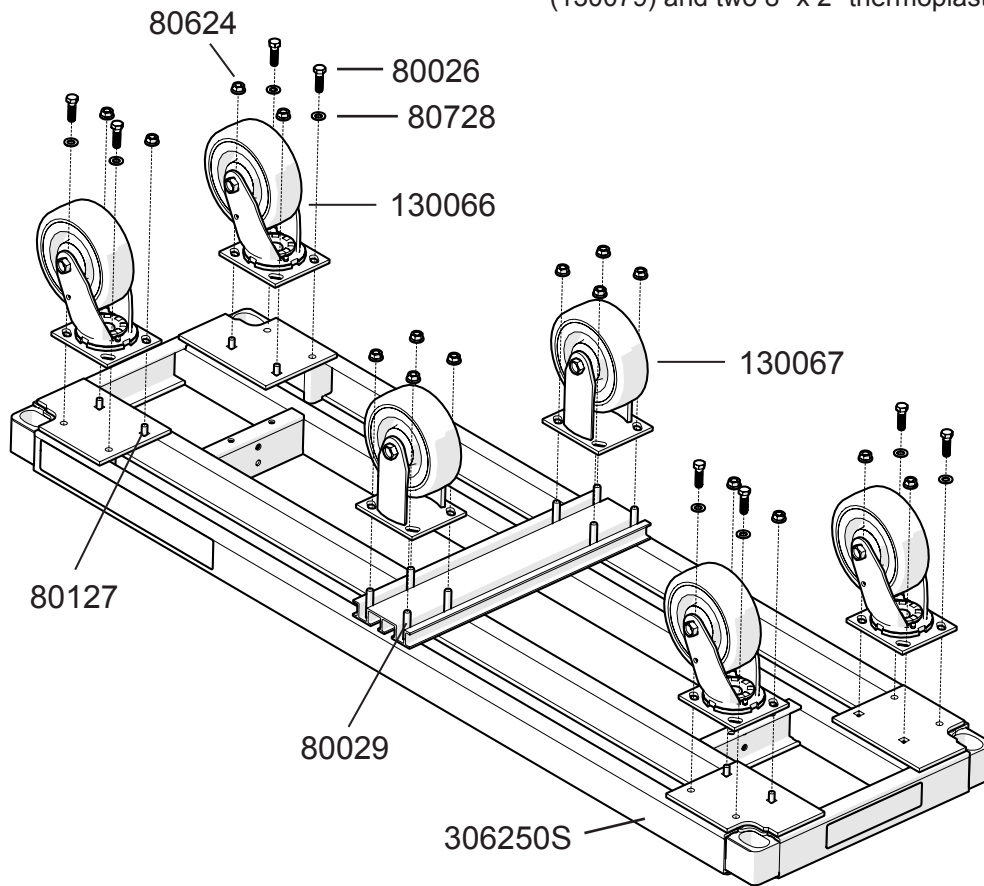

Figure 3



Figure 4

## CASTER ASSEMBLY INSTRUCTIONS

1. Using the 3/8"-16 x 1-1/4" long hex head screws, 3/8"-16 x 1" carriage bolts, 3/8"-16 flat washers and 3/8"-16 flanged hex lock nuts, attach all four of the 6" swivel casters onto the deck as shown in Figure 3.
2. Using the 3/8"-16 x 2" long hex head screws and the 3/8"-16 flanged hex lock nuts, attach both of the 6" rigid casters onto the deck as shown in Figure 3.
3. Position the handle as shown in Figure 4 and insert it into the sockets of the deck.

**NOTE:** Tighten all screws securely. (Recommended: The 3/8"-16 screws should be tightened to a torque value of 23 ft-lbs.)

# INDUSTRIAL BULK DELIVERY TRUCK - SOFT DRINK VERSION

## REQUIRED TOOLS

- (1) STANDARD 9/16" WRENCH
- (1) STANDARD SOCKET WRENCH
- (1) STANDARD 9/16" SOCKET

Description	Qty.	Part No.
Deck - 18" wide x 60" long	1	<i>Varies</i>
Handle	2	306150
Caster - 6" x 2" thermoplastic rubber swivel caster	4	130066
Caster - 6" x 2" thermoplastic rubber rigid caster	2	130067
Hardware Pack (consists of items below)	1	86625
Hex head cap screw - 3/8"-16 x 2" long	8	80029
Hex head cap screw - 3/8"-16 x 1" long	16	80025
Flat washer for 3/8" bolt	24	80728
Flanged lock nut - 3/8"-16	24	80624

Note: 8" caster models use four 8" x 2" thermoplastic rubber swivel casters (130079) and two 8" x 2" thermoplastic rubber rigid casters (130029).

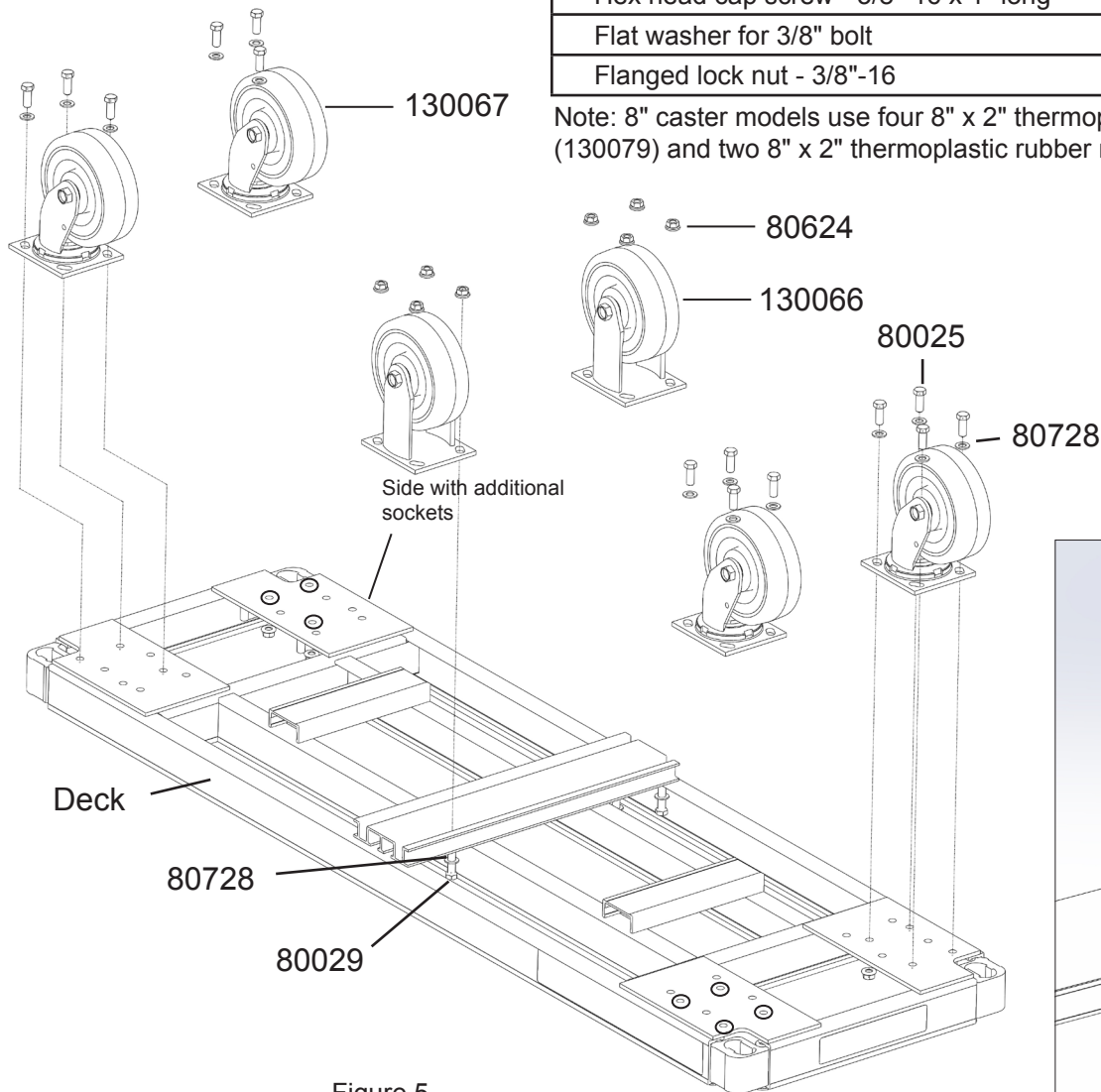

Figure 5

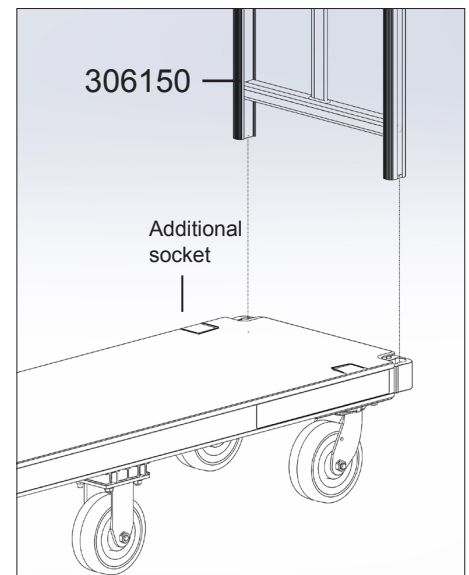

Figure 6

## CASTER ASSEMBLY INSTRUCTIONS

Note: If you have the soft drink model, you will only install 3 sets of hardware for each caster on the end of the deck with the additional end rack sockets as shown in Figure 6. All other casters use 4 sets of hardware. Extra hardware can be discarded.

1. Using the 3/8"-16 x 1" long hex head screws, 3/8"-16 flat washers and 3/8"-16 flanged hex lock nuts, attach all four of the 6" swivel casters onto the deck as shown in Figure 5.
2. Using the 3/8"-16 x 2" long hex head screws, the 3/8" washers and the 3/8"-16 flanged hex lock nuts, attach both of the 6" rigid casters onto the deck as shown in Figure 5.
3. Position the handle as shown in Figure 6 and insert it into the sockets of the deck.

**NOTE:** Tighten all screws securely. (Recommended: The 3/8"-16 screws should be tightened to a torque value of 23 ft-lbs.)